

YOU DESERVE A BREAK

Housing and Dining Services

Fall Break Information • November 2011



QUESTIONS

If you have any questions regarding this information, please see your Resident Assistant, email housing@mtu.edu, or give one of the following offices a call:

Housing 906-487-2682
Facilities 906-487-2740
Dining Services 906-487-2664

RECEPTION DESKS

All residence hall reception desks will close at **8:00PM on Friday, November 18**, and will reopen for normal business at **12:00PM on Sunday, November 27**.

There will be **no mail service during the break**. All mail will be held at the desks and slotted when the desks reopen.

All checked-out items must be returned to the desk by **8:00PM on Thursday, November 17**.

STAYING

If you are planning to stay in the hall during break, you must register at the reception desk by **Thursday, November 17**. You must also register if you are returning early, prior to **November 27**. There is no extra charge to stay over the fall break.

Kitchenettes will be open in all residence halls over the break period.

All residence hall entrances will be locked at 8:00PM on Friday, November 18. You can enter the building using your student ID while the doors are locked. The main entrance doors will reopen on **Sunday, November 27 at 12:00 noon**.

PARKING

We encourage you to leave your car at home if you don't use it on a regular basis due to the narrowing of parking lots in the winter.

If you are leaving your vehicle on campus during break, you must park it in the northwest side of commuter Lot 26 by **Sunday, November 20** and move it back into your assigned lot by **Sunday, November 27 by 11:00PM**. If you leave it in your assigned lot, it may be towed away at owner's expense. For more information, see your RA's posting board.

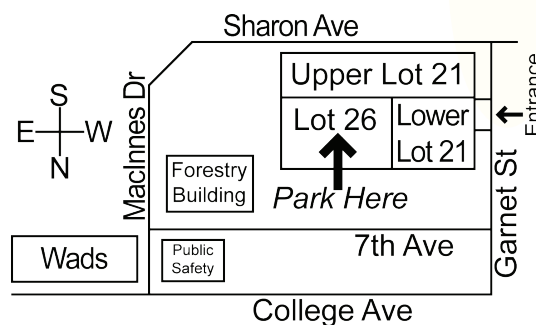

MEAL SCHEDULE

The Dining Halls will close after lunch in DHH and McNair, and after Dinner (6:00 PM) in on Wads **Friday, November 18**.

All 3 dining halls will reopen for breakfast on **Monday, November 28** at the normal serving hours.

Douglass Houghton Hall

November 14 - 17	Mon - Thurs
Continental Breakfast	7:00AM – 10:30AM
Lunch	10:30AM – 1:30PM
Deli Hour	1:30PM – 4:00PM

November 18	Friday
Continental Breakfast	7:00AM – 10:30AM
Lunch	10:30AM – 1:30PM

McNair Hall

November 14 - 17	Mon - Thurs
Continental Breakfast	7:00AM – 10:30AM
Lunch	10:30AM – 1:30PM
Deli Hour	1:30PM – 4:00PM
Dinner	4:00PM – 9:00PM

November 18	Friday
Continental Breakfast	7:00AM – 10:30AM
Lunch	10:30AM – 1:30PM

Wadsworth Hall

November 14 - 17	Mon - Thurs
Breakfast	7:00AM – 9:00AM
Continental Breakfast	9:00AM – 10:30AM
Lunch	10:30AM – 1:30PM
Deli Hour	1:30PM – 4:00PM
Dinner	4:00PM – 6:00PM

November 18	Friday
Breakfast	7:00AM – 9:00AM
Continental Breakfast	9:00AM – 10:30AM
Lunch	10:30AM – 1:30PM
Deli Hour	1:30PM – 4:00PM
Dinner	4:00PM – 6:00PM



CAMPUS CAFÉ

November 18 CLOSING at 1:00AM
Reopens Sunday, November 27 at 5:00PM

AFTERMATH CAFÉ & FUSION

November 18 CLOSING at 3:00PM
Reopens Monday, November 28

MUB FOOD MALL

November 18 7:30AM – 3:00PM
November 19 - 20 CLOSED
November 21 - 23 7:30AM – 3:00PM
November 24 - 27 CLOSED
Reopens Monday, November 28

LIBRARY CAFÉ

November 18 CLOSING at 3:00PM
November 19 - 20 CLOSED
November 21 - 23 8:00AM – 3:00PM
November 24 - 27 CLOSED
Reopens Monday, November 28

ENERGY & SECURITY

- Unplug any non-essential electrical equipment
- Refrigerators with food may be left on
- Close and lock your windows
- Turn off your lights
- Lock your door

DECORATING

Guidelines for holiday decorations:

- Trees and other decorations are only allowed in student rooms.
- To decorate in other areas, see the housing facilities manager for approval.
- Artificial trees are permitted, but natural trees are not due to their flammable nature.
- All electric items must have UL seal approval.
- No candles or flammable decorations.
- No electric devices are allowed on metallic trees.
- Decorations must be removed by no later than **12:00 noon on December 16.**

IRHC RIDEBOARD

Check out Michigan Tech's very own Rideboard:

<http://www.irhc.mtu.edu/orb/>

Do you need a ride someplace for break?
You can post a ride request for others to see.

Are you making a roadtrip and looking for an extra rider? Post your trip and others will find you.

Commuting to Tech and want to save gas?
Make a carpool listing today.

BIKE RACKS

Bikes must be removed from the racks by **Friday, November 18.**

Bike locks will be cut and bikes will be left unsecured after this date. This is necessary in order to move bike racks for snow removal. After the racks are moved, you may use them in the new locations.

You do **not** need to move bikes from: 1) the East McNair bike storage rack by the dining services loading dock, and 2) the Wadsworth Hall bike storage by entrance 4 and the trash compactor behind the building.

BIKE STORAGE

On-campus storage for your bike will be available November 12 and 13 from 2:00PM – 5:00PM through your hall council.

[Locations to bring your bike](#)

DHHC: office near Ballroom

MHA: west storage near courtyard

WHSA: office, Wadsworth G13

All bikes must be registered with the Department of Public Safety and Police Services (DPSPS) before being placed in storage.



Michigan Tech

Create the Future

Michigan Technological University is an equal opportunity educational institution/equal opportunity employer.

