

YOU DESERVE A BREAK

Housing and Dining Services

Fall Break Information for Hillside Place • November 2011



QUESTIONS

If you have any questions regarding this information, please see your Resident Assistant, email housing@mtu.edu, or give one of the following offices a call:

Housing 906-487-2682
Facilities 906-487-2740
Dining Services 906-487-2664

RECEPTION DESKS

All residence hall reception desks will close at **8:00PM on Friday, November 18**, and will reopen for normal business at **12:00PM on Sunday, November 27**.

There will be **no mail service during the break**. All mail will be held at the desks and slotted when the desks reopen.

All checked-out items must be returned to the desk by **8:00PM on Thursday, November 17**.

STAYING

There is no extra charge to stay over the fall break. Power and heat will remain on during the entire break.

All hall entrances will be locked at 8:00PM on Friday, November 18. You can enter the building using your student ID while the doors are locked. The entrance doors will reopen on **Sunday, November 27 at 12:00 noon**.

PARKING

We encourage you to leave your car at home if you don't use it on a regular basis due to the narrowing of parking lots in the winter.

If you are leaving your vehicle on campus during break, you must park it in the northwest side of commuter Lot 26 by **Sunday, November 20** and move it back into your assigned lot by **Sunday, November 27 by 11:00PM**. If you leave it in your assigned lot, it may be towed away at owner's expense. For more information, see your CA's posting board.

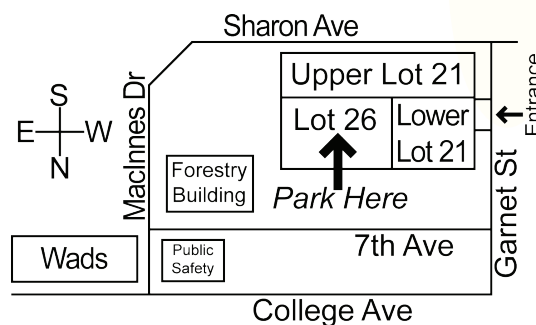

MEAL SCHEDULE

The Dining Halls will close after lunch in DHH and McNair, and after Dinner (6:00 PM) in Wads on **Friday, November 18**.

All 3 dining halls will reopen for breakfast on **Monday, November 28** at the normal serving hours.

Douglass Houghton Hall

| November 14 - 17 | Mon - Thurs |
|-----------------------|------------------|
| Continental Breakfast | 7:00AM – 10:30AM |
| Lunch | 10:30AM – 1:30PM |
| Deli Hour | 1:30PM – 4:00PM |

| November 18 | Friday |
|-----------------------|------------------|
| Continental Breakfast | 7:00AM – 10:30AM |
| Lunch | 10:30AM – 1:30PM |

McNair Hall

| November 14 - 17 | Mon - Thurs |
|-----------------------|------------------|
| Continental Breakfast | 7:00AM – 10:30AM |
| Lunch | 10:30AM – 1:30PM |
| Deli Hour | 1:30PM – 4:00PM |
| Dinner | 4:00PM – 9:00PM |

| November 18 | Friday |
|-----------------------|------------------|
| Continental Breakfast | 7:00AM – 10:30AM |
| Lunch | 10:30AM – 1:30PM |

Wadsworth Hall

| November 14 - 17 | Mon - Thurs |
|-----------------------|------------------|
| Breakfast | 7:00AM – 9:00AM |
| Continental Breakfast | 9:00AM – 10:30AM |
| Lunch | 10:30AM – 1:30PM |
| Deli Hour | 1:30PM – 4:00PM |
| Dinner | 4:00PM – 6:00PM |

| November 18 | Friday |
|-----------------------|------------------|
| Breakfast | 7:00AM – 9:00AM |
| Continental Breakfast | 9:00AM – 10:30AM |
| Lunch | 10:30AM – 1:30PM |
| Deli Hour | 1:30PM – 4:00PM |
| Dinner | 4:00PM – 6:00PM |



CAMPUS CAFÉ

November 18 CLOSING at 1:00AM
Reopens Sunday, November 27 at 5:00PM

AFTERMATH CAFÉ & FUSION

November 18 CLOSING at 3:00PM
Reopens Monday, November 28

MUB FOOD MALL

November 18 7:30AM – 3:00PM
November 19 - 20 CLOSED
November 21 - 23 7:30AM – 3:00PM
November 24 - 27 CLOSED
Reopens Monday, November 28

LIBRARY CAFÉ

November 18 CLOSING at 3:00PM
November 19 - 20 CLOSED
November 21 - 23 8:00AM – 3:00PM
November 24 - 27 CLOSED
Reopens Monday, November 28

DECORATING

Guidelines for holiday decorations:

- Trees and other decorations are only allowed in student rooms.
- To decorate in other areas, see the housing facilities manager for approval.
- Artificial trees are permitted, but natural trees are not due to their flammable nature.
- All electric items must have UL seal approval.
- No candles or flammable decorations.
- No electric devices are allowed on metallic trees.
- Decorations must be removed by no later than **12:00 noon on December 16.**

IRHC RIDEBOARD

Check out Michigan Tech's very own Rideboard:

<http://www.irhc.mtu.edu/orb/>

Do you need a ride someplace for break? You can post a ride request for others to see.

Are you making a roadtrip and looking for an extra rider? Post your trip and others will find you.

Commuting to Michigan Tech and want to save gas? Make a carpool listing today.

BIKE RACKS

Bikes must be removed from the racks by **Friday, November 18.**

Bike locks will be cut and bikes will be left unsecured after this date. This is necessary in order to move bike racks for snow removal. After the racks are moved, you may use them in the new locations.

You do **not** need to move bikes from: 1) the East McNair bike storage rack by the dining services loading dock, 2) the Wadsworth Hall bike storage by entrance 4 and the trash compactor behind the building, and 3) the bike storage area inside Hillside Place.

ENERGY & SECURITY

- Unplug any non-essential electrical equipment
- Clean out your refrigerator of perishable foods that may spoil during break
- Close and lock your windows
- Turn off your lights



MichiganTech
Create the Future

Michigan Technological University is an equal opportunity educational institution/equal opportunity employer.

